



All prices MSRP list. Call for discounts.

LIGHT TOWER PRICING GUIDE

Management • Critical Power Systems • Generator Procurement • Facility Management • Emergency Services • Contract Management • Forward Deployment • Infrastructure Planning • Leasing Facilities • Engineering Services • Project Consultation • Advanced Site Preparation • Full Service Integration • Management Systems • Disaster Response • Maintenance Contracts • Equipment Management • Engineering Services • Financial Services

Power to the worldwide marketplace...

Light Tower

LIGHT TOWER AL5000



Extra receptacle package available on 20 kW upgrade only.

Control box shown with optional Roda Deaco air shutdown system.

Specifications

- 30 ft (9.1 m) extended height floodlight produces enough light to illuminate 7-1/2 acres.
- Self-braking, erecting and extending hand-operated winch with self-lubricating steel cable is mounted inside the cabinet.
- Storage racks for light fixtures are also inside cabinet.
- Spring-loaded pin automatically locks galvanized 360° rotatable tower in upright position.
- Retractable power cord automatically recoils into protective rotatable mast sleeve to prevent damage when raising, lowering and moving tower.

- Light fixtures plug into weatherproof receptacle box at top of tower with UL and CSA-approved connectors.
- Individual quick-connect plug-in ballasts installed in galvanized steel boxes.
- Control panel is inside, away from the elements. Houses main and branch circuit breakers and hourmeter.
- Galvanized outriggers with pre-set position stops insure quick and proper spacing for safe operation in heavy winds.
- Single point lifting eye and forklift pockets provided for easy loading and unloading.

Light Tower AL5000

Specifications - Standard Unit

Lamps	Metal Halide 4 x 1,000 W
Generator	Brushless 60 Hz, 8.0 kW
Engine	Kubota diesel 13.6 hp
Fuel capacity	30 gal (114 L)
Wheel size	15 in (38 cm)
Axle rating	3,500 lbs (1,588 kg)
Tongue weight travel position	220 lbs (100 kg)
Total weight no fuel	2,425 lbs (1,101 kg)

Specifications - 20 kW Upgrade

Lamps	Metal Halide 4 x 1,000 W
Generator	Brushless 60 Hz, 20 kW
Engine	Isuzu diesel 34.5 hp
Extra Receptacle Package	
3 each – 30 amp	125/250 volt Twistlock
2 each – 20 amp	120/240 volt GFCI
Fuel capacity	30 gal (114 L)
Wheel size	15 in (38 cm)
Axle rating	3,500 lbs (1,588 kg)
Tongue weight travel position	220 lbs (100 kg)
Total weight no fuel	2,735 lbs (1,245 kg)

Optional Equipment

Block heater	3/8" Highway safety chains with snap hook
Tough coat paint (front of unit and trailer)	Spare tire and wheel
Plastic fenders	Rubber door hold-down latches
Rock shield (under entire unit)	Extra GFI duplex receptacle with breaker
60 gallon dual fuel tank system	Low temperature coolant mixture (-40 deg F)
Combination ring/ball hitch	Battery heater blanket
Tail light package	Auto-start/stop**
1000 CCA battery	Metal halide 6 x 1,000 W or 8 x 1,000 W lamps
Fuel line heater	
Roda Deaco electronic air shutdown system*	

Dimensions

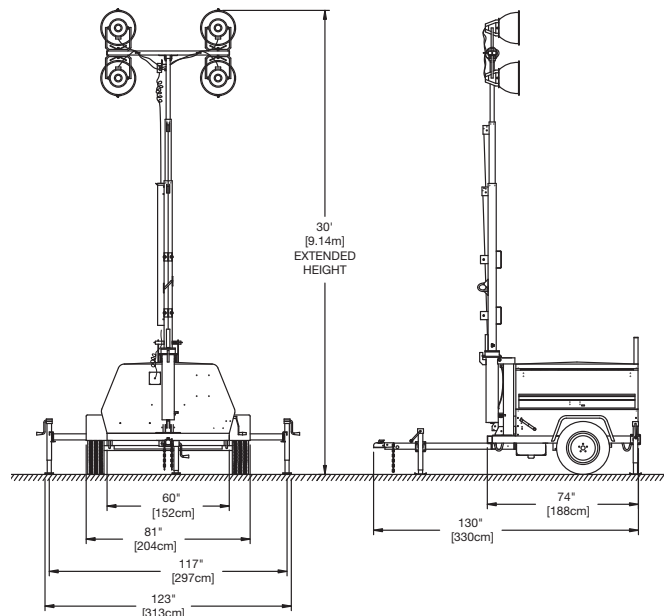
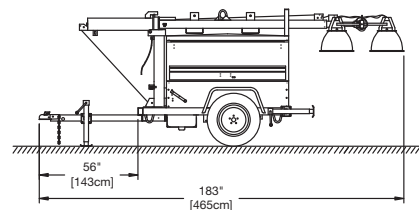
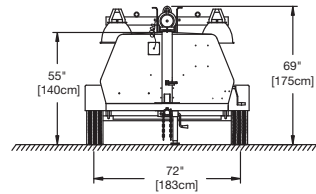

*Extra GFI and auto-start/stop not available with this system.

**Not available with 8 light configuration.



Genie Industries, Inc.

For more information, product demonstration, or details on purchase, lease and rental plans, please contact your local Genie Distributor.



TEREX®

2008 Price List Light Towers AL5000

<u>Standard Features</u>	<u>Model</u>	<u>List Price</u>
Chassis	AL5000 Internal Storage	\$14,465
60 Hz, 8 kW generator		
13.6 hp Kubota diesel engine		
8 kW Leroy Somer generator set		
Low oil pressure and high temperature engine safety shut down		
One 30A/240V T/L receptacle		
One GFI protected 20A/120V duplex receptacle		
30 gal fuel tank		
3,500 lbs Heavy-duty axle		
P205/75C15 tires		
Three 3,000 lbs plated screw jacks		
Plug-in ballasts		
Pneumatic gas lift springs on enclosed doors		
Acoustic foam sound insulation in doors		
Dome light inside cabinet		
	<u>Options (add to model base price)</u>	
	20 kW Isuzu/Newage genset (includes cabinet for external receptacle package, and 2 ea. 20A/120V GFI & 3 ea. 30A/240V T/L, 700 CCA battery upgrade)	\$5,315
	Combination ring and ball hitch	\$145
	Ring hitch, 2.5 in.	\$60
	DOT approved run, stop, turn lights, 4 pole plug	\$130
	7 pole connector for light package	\$30
	3/8 in. highway safety chains with snap hook	\$35
	4 outriggers and jacks (one each corner)	\$315
	60 gal fuel capacity	\$430
	Spare tire and wheel	\$305
	Extra GFI duplex receptacle with breaker	\$80
	Tough coat paint surface (cabinet / trailer front)	\$295
	Electric trailer brakes	\$465
	Hydraulic surge brakes/ring hitch	\$960
	Hydraulic surge brakes/ball hitch	\$925
	Sound attenuation package with directed ventilation	\$420
	Electric 12V winch in lieu of manual	\$780
	Export racking/preparation	\$500
	Export crating/preparation	\$610
	Battery heater blanket	\$120
	700 CCA battery	\$85
	Fuel line heater	\$210
	Fuel/water separator-filter	\$155
	Low temperature coolant mixture (-40° F)	\$30
	Engine block heater for Kubota D905 and D1105	\$60
	Engine block heater for Isuzu	\$55
	Plastic fenders in place of steel	\$45
	Rubber door hold-down latches	\$45
Tower		
Four 1000W metal halide lights		
Hand winch operated 30 ft.		
Telescoping galvanized tower		
Retractable coiled power cord		
Quick disconnect fixtures		

*Special paint available

*Other lighting types available

Effective Date: January 1, 2008. Product specifications and prices are subject to change without notice or obligation. All prices are in U.S. dollars F.O.B. Factory. Products and services listed may be trademarks, service marks or trade-names of Terex Corporation, Genie Industries, Inc. and/or their subsidiaries in the U.S.A. and many other countries. All rights are reserved. Terex® is a registered trademark of Terex Corporation in the U.S.A. and many other countries. Genie® is a registered trademark of Genie Industries, Inc in the U.S.A. and many other countries. Genie is a Terex Company. Copyright © 2007 Terex Corporation.

Updated - October 1, 2007